

## OE72 SPECIFICATIONS



## DIMENSIONS

---

Length overall	22.00 m	72.2'
Length at waterline	21.92 m	72.0'
Beam	10.92 m	35.8'
Draft board down	3.00 m	9.84'
Rudder draft	1.9 m	6.23'
Height of mast from water	32.6 m	107.0'
Main sail area	158.0 m <sup>2</sup>	1700 ft <sup>2</sup>
Jib sail area	134.0 m <sup>2</sup>	1442 ft <sup>2</sup>
Engine	2 x 150 hp YANMAR	
Fuel capacity	1660 L	438.5 Gal
Water capacity	800 L	211.3 Gal
Heated water	2 x 75 L	2 x 19.8 Gal
Classification	CE-Ocean A (DNV-GL)	
Naval architect:	Germán Frers	
Builder:	Ocean Explorer by OQS	

## CONSTRUCTION

The construction of the Ocean Explorer catamarans is made using only premium materials with properties meeting all design criteria for the vessel. All structural parts are checked by third party surveyor in addition to standard practice checks by notified body. This pushes the Ocean Explorer catamarans to a quality and workmanship level in world class.

---

### RCD Status:

- Our understanding is that the vessel complied with the European Union Recreational Craft Directive and is Categorised CE- Ocean A
- Original construction in compliance with MCA classifications.

### Hull Construction:

- Vacuum infused, epoxy resin, e-glass, and stringers are made in carbon fibre.
- Structural bulkheads pre-preg.
- The shroud chainplates are made in carbon fibre and integrated in the hull laminate.
- Hull and deck will be painted with Awlgrip
- White hull in Awlgrip
- White Awlcraft deck

### Deck & Superstructure Construction:

- The deck is vacuum infused, epoxy resin, e-glass and carbon reinforced at high load areas.
- The top deck, saloon made in carbon fibre.
- Fore and aft deck painted with non-skid surface, white colour
- Aft cockpit and stairs to upper deck and down in transom deck painted anti-skid.
- The deckhouse structural frame made of carbon fibre.
- Laminated/tempered glass all around
- On the roof side stainless steel grab rails are installed for safety.
- Anti-slip surface paint on appropriate places.
- Steps for easy access to roof installed



### Daggerboards & Rudders:

- Carbon fibre curved asymmetric daggerboards "C foils" raising and lowering with push buttons from helm station.
- Rudders made of glass fibre
- Minimum draft of rudders – 1.80m

## MACHINERY

The machinery and propulsion solutions are designed for best usage and optimized for this vessel. All design is based on useability and comfort. But to meet all possible requirements there is a great variety of options and customisations that can be incorporated to an Ocean Explorer Catamaran.

---

### Drive Units:

- 2 x 150 hp Diesel Yanmar engine
- V-drive gearbox with an optimal angle for the shaft.
- The machinery space is insulated with fire retardant insulation materials forward for noise control to ensure a quiet yacht.
- Semi automatic fire protection in engine rooms CO2
- Electric motor options are available with different suppliers below the already proven concept:
- 2x Torqeedo 'Deep Blue' 100 kW inboard drive motor, 2400 rpm with 3 x System Management Units located in machinery spaces to aft of each hull.
- V-drive gearbox with an optimal angle for the shaft.
- 2x Electronic Throttle with 7" System Control Displays, Data cable, HV power cable & Thrust Bearing.
- Electrical system used in conjunction with 20m<sup>2</sup> of solar panels on the roof, hydrogenation with the electrical motors and a battery bank optimized to meet world cruising demands while maintaining a light displacement for improved vessel performance.

**Propulsion & Steering:**

- Bruntons feathering propellers
- Electric Hydraulic steering system – Option for fly-by wire steering
- Twin carbon fibre helm wheels

**ELECTRICAL SYSTEMS**

The electrical systems are designed and installed for easy maintenance and easy use. With an industrial level automation system as standard on the vessels the boat will be state of the art in all aspects also giving endless possibilities for development of the systems.

---

**Voltage systems:**

- 24vDC domestic system 220vAC system via shorepower or inverter

**Battery Banks:**

- 8 x 200 ah Mastervolt Li-ion 24vDC service batteries.
- 12vDC generator & main engines starter batteries

**Battery Charger:**

- 2 x 100 Amp Automatic Battery charger

**Inverter:**

- Mastervolt MASS Sine 24/8000 5kw DC-AC inverter

**Generators:**

- Fisher Panda 18kw 220vAC diesel Generator.

**Solar (Option):**

- Solar panels on roof, total area 20 m2 of the most efficient panels currently available

- 3kw Solar charge regulator

### **Hydrogeneration (Option for Electric motor):**

- Hydrogeneration with the electrical motors and a battery bank optimized to meet world cruising demands while maintaining a light displacement for improved vessel performance.

### **Shorepower:**

- Shorepower 220 V 50- 60 hz
- 220vAC sockets throughout interior

### **Automation and Control Systems:**

- Monitoring system for tanks
- Controls for electrical systems
- Sail Controls
- Lights controls
- Hydraulic control
- Generator control

## **PLUMBING & GAS SYSTEMS**

The plumbing systems onboard are designed to keep the maintenance and usage of the boat care free, however when there are challenges, main systems trouble shooting and maintenance are supported by the automation system of the boat.

---

### **Fresh Water:**

- Fresh water pressurised by 24vDC centrifugal pressure pumps with accumulator tank
- Hot water supplied by engine driven calorifier in Isotemp 150 litre hot water tanks with 220vAC immersion heater elements

**Bilge Pumps:**

- Each hull is divided into separate flooding sections, each section with own 24vDC bilge pumps.
- All bilge pumps have external sensors.

**TANKAGE**

Dimensioning of tanks and systems are configured so the boat easily can handle owners and guests for long periods away from shore.

---

**Fuel:**

- 1600 litres of generator diesel fuel capacity in 2 tanks with transfer between hulls with electrical pump

**Fresh Water:**

- 860 litres of fresh water capacity in 2x 430 litre plastic tanks with transfer between hulls with electrical pump

**Holding Tanks:**

- 2x 300 litre blackwater holding tanks discharging overboard or via deck extraction points

**NAVIGATION & COMMUNICATION EQUIPMENT**

Navigation & communications equipment is carefully decided together with the builder to provide the owner with the best possible set-up depending on the needs and desires.

---

## DOMESTIC EQUIPMENT

---

### Standard Galley Includes:

- 4 burner gas stove with oven
- Isotherm DR190 fridge
- Frigonautica FR130 fridge
- Isotherm 130 (drinks fridge)
- Extraction fan from hob

### Heads:

- 4x Sanimarin 24vDC combined toilets with bidet function
- 4x showers with hot & cold pressurised supply

### Heating & Ventilation:

- Forced fresh air ventilation in hulls comes as standard

### Entertainment:

- Fusion stereo system
- Full Entertainment system to be decided and specified as option

## ACCOMMODATION

---

### Summary of Accommodation:

- The contemporary styling of the OE 72 with clean lines and sleek deckhouse design, allow for panoramic views without compromising on the look of the yacht.
- The interior layout of the OE 72 is second to none, with the ingenious use of space to optimise the functionality, while retaining the elegance and spacious feel.



- Her two guest cabins are all ensuite, with large double beds, all ensuite, with the owner's cabin taking up the majority of the starboard hull, plus a further double crew cabin (or occasional guest cabin in the forward section of the starboard hull).

**Accommodation Finish:**

- Oak interior glued onto divynylcel core
- Composite flooring in showers
- Options for blinds for the cabin windows
- Shower doors in Acrylic

**Accommodation layout from Forward:**

- The accommodation layout can be from 3 to 5 cabin layout with additional options for a forward crew cabin.
- The example shows a 4 cabin layout with separated owners cabin. All cabins have large hull windows as standard.

**Forward Guest Cabin Port:**

- Double bed
- Hanging locker with drawers
- Option for openable portlight outboard
- Ensuite including head and shower

**Forward Cabin starboard (Crew Cabin)**

- Crew cabin moved forward to allow for extra space in owners suite
- Separate stairs
- Double bed
- Storage under the bed and hanging locker
- Hull window portlight outboard
- Ensuite

**Aft Guest Cabin Port:**

- Option for openable hull portlights outboard
- Ensuite including head and shower
- Hanging lockers and storage

- Sleeping area includes two beds that can be joined together to form a double bed.

#### Aft Owner's Cabin Starboard:

- Private entrance to Suite
- Hanging lockers and storage space
- Queen size double bed
- Ensuite
- Options for openable windows outboard

#### Saloon

- Large open space with open galley and seating
- Navigation station
- L or U shaped seating
- Large dinner table
- Cooktop island in galley

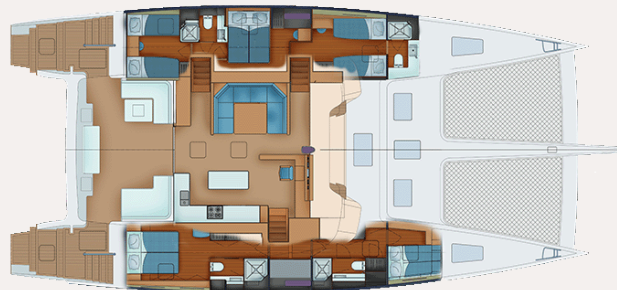
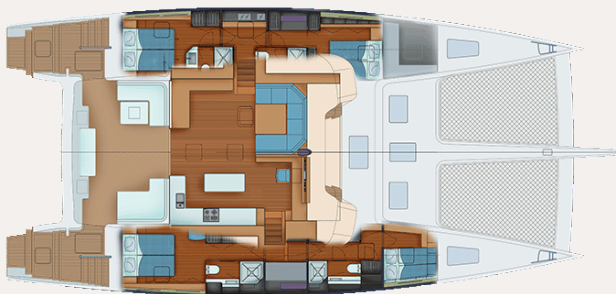

## DECK EQUIPMENT

---

### Rig:

- Lorima white painted carbon fibre mast – 32.72m air-draft
- Lorima white painted V-profile carbon fibre boom
- Aramid / Navtec Standing Rigging

- Structural carbon composite front cross beam moulded with the hulls and deck
- Carbon fibre articulated bowsprit with carbon bobstay
- Lazyjacks for mainsail
- Spinlock jammers
- Sheets and halyards to be agreed upon with OQS team
- All sail handling including sheets and halyard lines go aft to the helm station
- Traveller on roof, hydraulic.
- Option for line reeler for main halyard by electric winch under helm station
- The lines for sail handling coming from the rig brought under deck to the helm stations.

**Winches:**

- Harken 990.3 ST FD AAA 24V HO1R + DFCB
- Harken 990.3 ST FD AAA CR 24V HO1R + DFCB COUNTER ROTATING
- Harken 990.2 ST FD AAA 24V HO1R + DFCB
- Harken 990.2 ST FD AAA CR 24V HO1R + DFCB COUNTER ROTATING
- 2x Harken 80.3 STEP EL 24V HO DFCB included
- Harken 65.3 STREL 24 V +DFCB

**Sails:**

- Square top, full battened Mainsail
- Self tacking Jib

**General:**

- Stainless steel foldable boarding ladders on both sides
- Two hatches forward for access to sail storage.
- One hatch with glass for access to workshop (with workshop option)
- Four hatches to access equipment and storage in front of the deckhouse.
- One deck hatch to the crew cabin fwd. SB side.
- Deck hatch installed to the owner's cabin and guest cabin aft in port side.
- One hatch each side to access generator and motor compartment aft in the boat.
- Several smaller hatches for storage and inspection hatches for equipment.
- Option for hatches in the deckhouse

- Pushpit and pulpits are made of stainless steel and mounted on bow and transom. Navigation lights (LED) installed in the push and pulpits.
- Stainless steel stanchions with triple lifelines.
- Custom cleats for mooring aft

**Aft Cockpit Arrangement:**

- Large dining area on SB side. Relaxing sun bed area on port side.
- Curtesy lighting installed in cockpit and aft area including stairs down. Led strip in all steps and double downlights small led on lower steps, single on upper steps.
- Sunbathing area, square with storage compartment underneath.
- The aft end of the cockpit with sofa.
- Hatch in floor made for storage.
- Access to the steering system from the back side of the aft coaming.
- Seating position integrated in the pushpit forward, seating for 2 persons.

**Anchoring & Mooring:**

- Lofrans Tigres electric windlass
- 68kg anchor with 80m of 12mm chain
- Custom chain lock
- Option for Pop-up mooring cleats

**Covers, Cushions & Canvas (option):**

- Aft cockpit tent of durable material with windows provided, installed on tracks under roof in aft cockpit.
- Covers for deckhouse windows.
- All mattresses in aft cockpit in Sunbrella material.
- Sunbrella covering along edge of the rooftop with windows.
- Sunbath mattress for foredeck, cushions, canvas for outside areas

**Tender & Outboard (Option):**

- Pair of white painted aluminium davits with built in hydraulic lifting system on each
- Options for tender