

ocean EXPLORER 72



OE72

READY TO EXPLORE

Made for adventurers

The Ocean Explorer Catamaran is an oceangoing expression of your dreams. An adventure at sea filled with unforgettable memories you'll cherish every day for the rest of your life.

ACROSS THE SEAS

Make way for new destinations

The OE72 designed by German Frers offers innovative elements reflected in the accommodation and deck arrangement. Whether you plan to cruise stylishly around the world or race comfortably at 25+ knots offshore the OE72 will be the perfect platform to reach your goals. A highly efficient green circumnavigation machine to get off the grid entirely, or even into the ultimate microlight offshore racing multihull with the latest foiling package.

OE72





THE DESIGN

Germán Frers

The combination of the design by Frers and the experience behind the OQS team will provide you with the best yachting experience ever. Expert craftsmanship, superior design, and the advanced hydrodynamic shape of the hull all help to ensure that each Ocean Explorer Catamaran delivers true sailing performance. The OE72 model provides a platform for making your dream catamaran happen.

THE POWER OF THE CAT

Breaking the barriers

The advanced hydrodynamic shape of the hull, designed by world-renowned naval architect Germán Frers, utilizes the optimal length to beam ratio to minimize the wetted surface and deliver true performance. Instead of opting for fixed keels, a daggerboard configuration was chosen based on the advantages of providing lift, and lateral resistance versus drag. This design is also more efficient by providing outstanding upwind performance with the daggerboards down, and best performance with daggerboards up in a reaching or running sailing angle.





STEP INSIDE

True luxury and comfort

The OE72 provides a sense of home by making the most of every square foot. The saloon design is spacious for maximum enjoyment with an entertainment area, and the galley equipment has everything you could expect from a professional kitchen. The interior has curves and clean, sweeping lines to match the sleek exterior. Not even one precious moment to miss when you spend time in the saloon. With the panoramic windows, the astonishing view of the ocean to adore wherever you turn your head. The interior design enhances your sailing experience by providing you with the most exceptional liveaboard comfort customized to reflect your taste.

IT'S IN THE DETAILS

True craftsmanship

Your cabin is the first space you see in the morning and the last to see at night. You are surrounded by beautiful textures, the finest material, and finishes in each cabin, making them the perfect spaces to unwind after long days of racing or exploring.





Cruising layout

The four-cabin standard layout provides easy sailing and ample spaces for all cabins and living areas with enclosed showers and heads. The layout is specifically designed for long periods onboard. In addition, the standard layout consists of a separate crew area with plenty of storage space for anything you might need onboard.

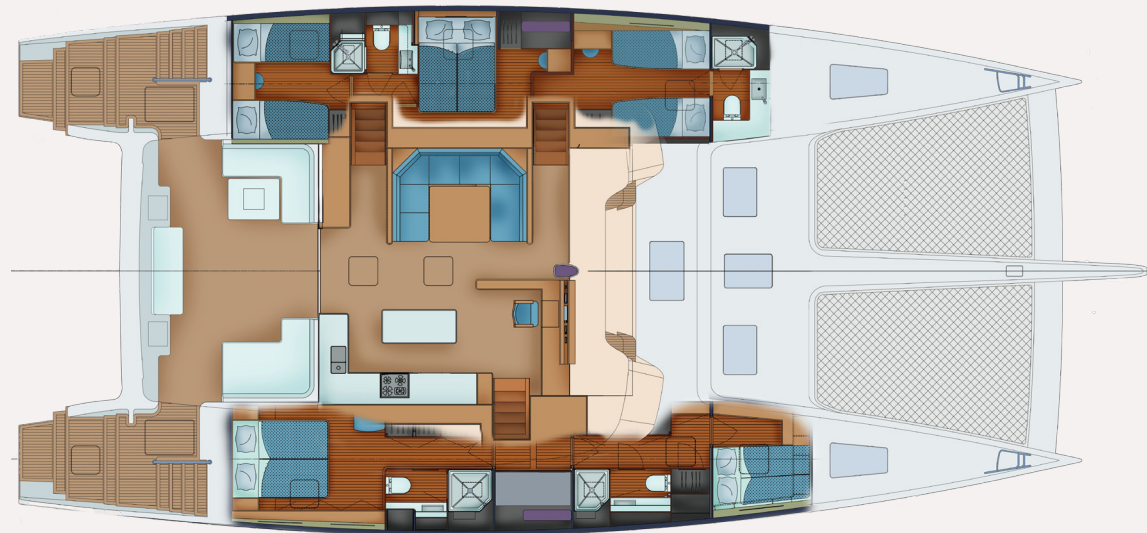

Cruising 5 cabin layout

The 5 cabin layout is designed for cruising with more prominent families or could even be used as a luxury charter catamaran. All areas are designed keeping comfort and luxury in mind. The 5 cabin layout will maintain living space over cabin space.



GP layout

The GP layout is designed for the ones that will focus on performance and speed. This layout will still have large cabins and living spaces, but with an ultra-light interior, this configuration will give an advantage in weight and performance. In addition, the storage for a proper sails garderobe is not compromised with this layout.

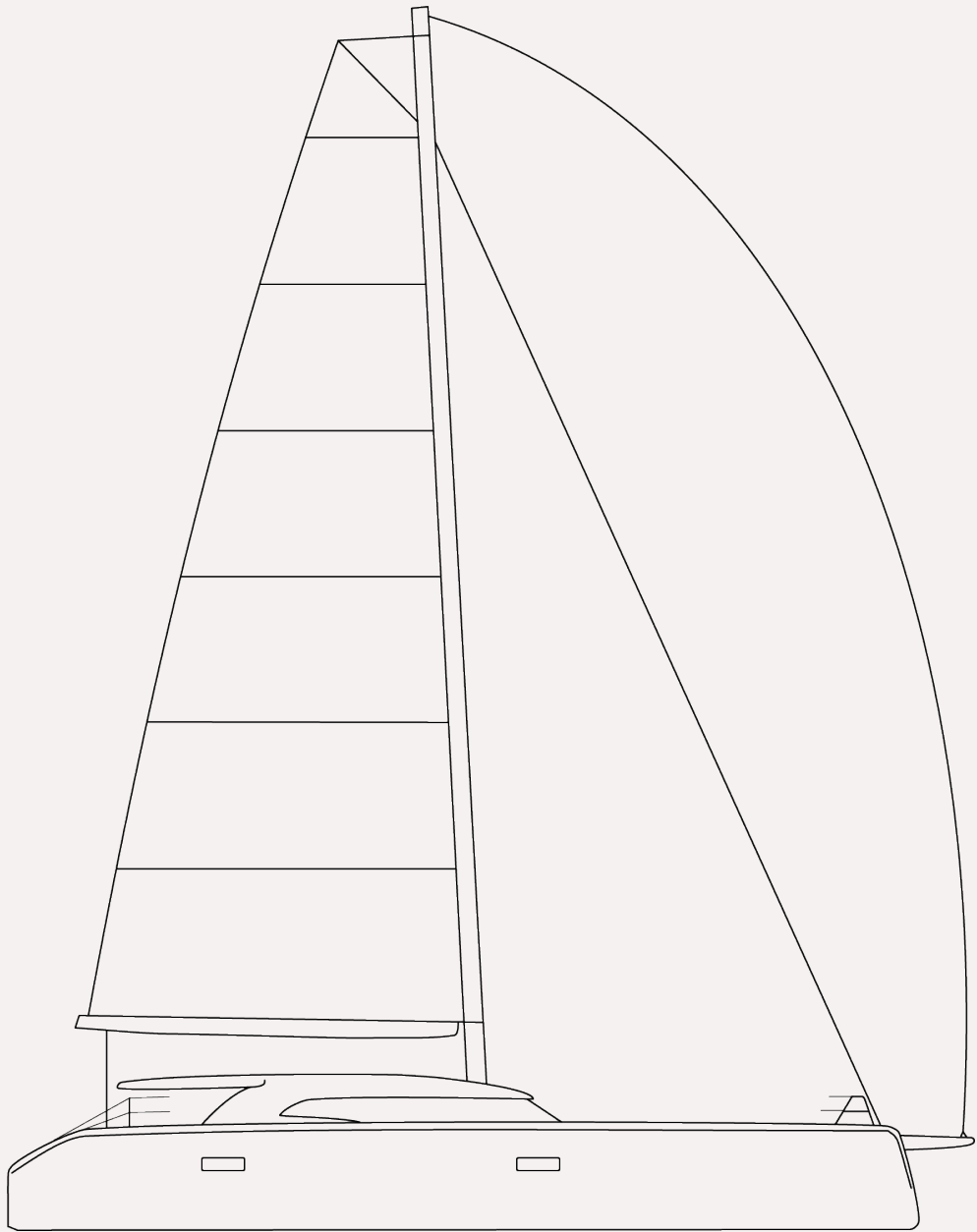

SPECS

LENGHT OVERALL	22.00 M / 72.2'
LENGHT AT WATERLINE	21.95 M / 72.0'
BEAM	10.92 M / 35.8'
HULL DRAFT	0.68 M / 2.23'
DRAFT BOARD DOWN	3.00 M / 9.84'
RUDDER DRAFT	1.9 M / 6.23'
HEIGHT OF MAST FROM WATER	32.6 M / 107.0'
MAIN SAIL AREA	158.0 M2 / 1700 FT2
JIB SAIL AREA	134.0 M2 / 1442 FT2
DISPLACEMENT LIGHTSHIP	32.8 TONS / 72311 LBS
ENGINE	YANMAR DIESEL 2 X 150 HP
PROPULSION	V-DRIVE AND SHAFT
FUEL CAPACITY	1660 L / 438.5 GAL
WATER CAPACITY	800 L / 211.3 GAL
HEATED WATER	2 X 75 L / 2 X 19.8 GAL
SOLAR ENERGY AREA	20.6 M2 / 222 FT2
CLASSIFICATION	CE-OCEAN A (DNV-GL)
NAVAL ARCHITECT	GERMÁN FRERS

* These figures are preliminary and will be dependent on owner specifications

APPLIED INNOVATION

Green emission

We are always one step ahead regarding user experience, usability and comfort. By embracing new ideas and applying advanced technology intertwined with our build experience, we provide complete solutions that result in a unique and state-of-the-art catamaran.



PRESS REVIEW

"...Conclusion

Fast, comfortable and serene exploration of the oceans were the owner's specifications, and this corresponds in every way to what the design and production teams have actually achieved with this OE72. This luxurious catamaran is more like a three-quarter custom than a semi-custom. This particularly elegant limousine of the seas guarantees its owner sensations under way and life on board that have never been explored before. So much so that the accuracy and balance of the concept are unprecedented."

Norbert Conchin



OE72



READY, SET, GO!

Enjoy dreamlife at sea

Grab the helm, discover new surroundings and fully experience your freedom on the water.

OE72

info@oceanexplorer.fi